

THE DOLDER GRAND

21 October 2020

SAFETY CONCEPT DOLDER GRAND - ROOMS

PROTECT YOURSELF AND OTHERS ✓

More important than ever: stop the rise in infection numbers.

Keep a distance.

Wear a face mask if it is impossible to maintain that distance.

Wash your hands thoroughly.

Do not shake hands.

Cough and sneeze into your elbow.

Only visit a doctor's office or an accident and emergency department after making an appointment by phone.

If you experience symptoms, get tested immediately and stay at home.

To enable contact tracing, always provide your complete contact information.

To break infection chains: download and activate the SwissCovid app.

If you test positive: isolate. If you have had contact with a confirmed case: quarantine.

www.foph-coronavirus.ch

MASK REQUIREMENT

- It is mandatory to wear a mask in all public areas of the Dolder Grand. You can take it off while you are seated.

HYGIENE MEASURES

- Please disinfect your hands when entering the Hotel. Hand hygiene stations are available at the entrances.
- We kindly ask you to maintain a distance of 1.5 metres from other guests and from employees.
- The room key cards will be disinfected at check-in and check-out.
- Only the same group of guests is allowed to use the same lift. Employees use the next lift.
- The rooms are cleaned according to the highest hygiene standards. We recommend that you do not stay in your hotel room when cleaning is in progress.
- In addition, the following 10 high touchpoints are disinfected in the hotel room before every arrival:

- 1 Door bell
- 2 Handles and knobs
- 3 Window / Balcony door handles
- 4 iPad
- 5 TV remote control
- 6 Telephone
- 7 Light switches
- 8 Safe
- 9 Coffee machine
- 10 Hair dryer

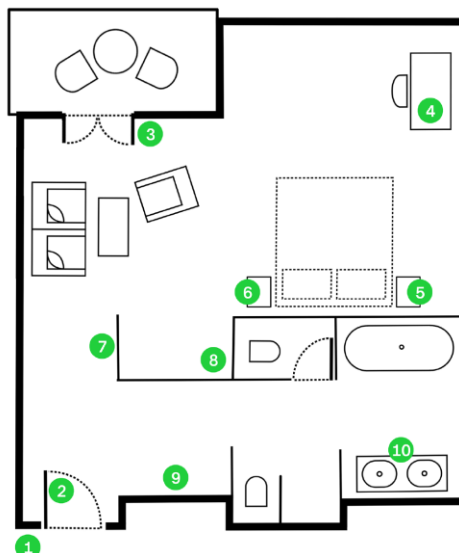

THE DOLDER GRAND

21 October 2020

- All surfaces and objects in the hotel rooms and the public areas will be cleaned regularly with a professional cleaning agent or disinfectant.
- In our shuttle bus and limousine, guests and the driver must wear a hygienic mask, as the minimum distance of 1.5 m cannot be maintained.
- Only healthy employees are allowed to come to work. We therefore ask that our guests visit us only if they are completely healthy.

Thank you for your understanding.

We are looking forward to seeing you!